

# Emergency stop switch

84-5320.0020

Distribution by  
Newark



<https://newark.eao.com/component/84-5320.0020...>

Your product:

---



## 84-5320.0020 Emergency stop switch

*Loading ...*

### FRONT

**Front dimension:** Ø 32 mm

**Front form:** Round

### MOUNTING

**Mounting cut-out:** Ø 22.3 mm

**Mounting type:** Panel mounting

### OPERATING-/INDICATION PART

**Lens colour:** Red-white

**Lens material:** Plastic, according to UL 94 V0

**Lens illumination:** Non illuminated

**Lens shape:** Mushroom-head

**Lens optics:** opaque

**Lens:** round

**Switching position ring:** Green

### ELECTRICAL CHARACTERISTICS

**Switching voltage and switching current:**

|  |               |                |
|--|---------------|----------------|
| Switch rating AC with silver contact (gold plated) |               |                |
| Service category AC-15 as per EN IEC 60947-5-1     |               |                |
| Voltage  | 120 VAC       | 240 VAC        |
| Current  | 3 A           | 1,5 A          |
| Switch rating AC with silver contact (gold plated) |               |                |
| Service category DC-13 as per EN IEC 60947-5-1     |               |                |
| NO contacts  | NC contacts   | NO/NC contacts |
| (48 VA)  | (60 VA)       |                |
| 12 VDC/2.0 A                                       | 12 VDC/2.5 A  | 125 VDC/0.22 A |
| 24 VDC/2.0 A                                       | 24 VDC/2.5 A  | 250 VDC/0.11 A |
| 48 VDC/1.0 A                                       | 48 VDC/1.25 A |                |
| 60 VDC/0.8 A                                       | 60 VDC/1.0 A  |                |

|  |  |                               |  |         |          |         |      |
|--|--|-------------------------------|--|---------|----------|---------|------|
| <b>Contacts:</b>                             | 1 NC   |                               |  |         |          |         |      |
| <b>Rated Operational Voltage Ue:</b>         | 250 VAC/DC according to EN IEC 60947-1   |                               |  |         |          |         |      |
| <b>Rated impulse withstand voltage Uimp:</b> | 4 kV, according to EN IEC 60947-1  |                               |  |         |          |         |      |
| <b>Rated insulation voltage Ui:</b>          | 250 V according to EN / IEC 60947-1  |                               |  |         |          |         |      |
| <b>Rated short-circuit current caused:</b>   | 1 000 A, type of short-circuit device 6 A gG (EN 60947-5-1)  |                               |  |         |          |         |      |
| <b>Recommended minimum operational data:</b> | <table> <tr> <td>Silver contacts (gold plated)</td> <td></td> </tr> <tr> <td>Voltage</td> <td>1 VAC/DC</td> </tr> <tr> <td>Current</td> <td>1 mA</td> </tr> </table> | Silver contacts (gold plated) |  | Voltage | 1 VAC/DC | Current | 1 mA |
| Silver contacts (gold plated)                |  |                               |  |         |          |         |      |
| Voltage                                      | 1 VAC/DC   |                               |  |         |          |         |      |
| Current                                      | 1 mA   |                               |  |         |          |         |      |
| <b>Switching rating:</b>                     | 250 V AC @ 1,5 A   |                               |  |         |          |         |      |
| <b>Electrical lifetime:</b>                  | 50 000 cycles of operation   |                               |  |         |          |         |      |
| <b>Electric strength:</b>                    | 500 VAC, 50 Hz, 1 minute according to DIN IEC 60512-2  |                               |  |         |          |         |      |
| <b>Overvoltage category:</b>                 | III, according to EN / IEC 61058-1   |                               |  |         |          |         |      |
| <b>Pollution degree:</b>                     | 3, according to EN IEC 60947-1   |                               |  |         |          |         |      |
| <b>Protection class:</b>                     | II, according to EN / IEC 60947-5  |                               |  |         |          |         |      |
| <b>Standards:</b>                            | According to EN 60947-5-1, EN 60947-5-5, DIN EN ISO 13850, EN IEC 60204  |                               |  |         |          |         |      |
| <b>Thermal current Ith:</b>                  | 5 A  |                               |  |         |          |         |      |

## MECHANICAL CHARACTERISTICS

|                             |                                |
|-----------------------------|--------------------------------|
| <b>Terminal:</b>            | Plug-in terminal, 2.8 x 0.5 mm |
| <b>Contact material:</b>    | Gold                           |
| <b>Switching action:</b>    | Maintained                     |
| <b>Switching system:</b>    | Slow-make switching element    |
| <b>Release type:</b>        | Twist to unlock                |
| <b>Mechanical lifetime:</b> | 250 000 cycles of operation    |
| <b>Operating force:</b>     | 20 N ±4 N                      |
| <b>Operating Travel:</b>    | ca. 4 mm                       |

**Tightening torque:** Fixing nut 0.8 Nm

**Weight:** 0.024 kg

## **AMBIENT CONDITION**

**IP front protection:** IP65, IP66, IP67, according to DIN EN 60529

**IK Protection:** IK07 as per IEC 62262

**Operating temperature:** – 25 °C ... + 70 °C

**Storage temperature:** – 25 °C ... + 85 °C

**Shock resistance:** Max. 150 m / s<sup>2</sup>, pulse width 11 ms, 3-axis, (semi-sinusoidal as per EN IEC 60068-2-27)

**Vibration resistance:** Max. 50 m / s<sup>2</sup> from 10 Hz ... 500 Hz, 10 cycles, 3-axis (sinusoidal EN IEC 60068-2-6)

**Climate resistance:** Damp heat, cyclic: 96 hours, + 25 °C/97 %, + 55 °C/93 % relative humidity, as per EN IEC 60068-2-30  
Damp heat, steady: 56 days, + 40 °C/93 % relative humidity, according to EN IEC 60068-2-78  
Saline mist: 96 hours, + 35 °C in chemical solution NaCl, as per EN IEC 60068-2-11  
Dry heat: 96 hours, + 70 °C, as per EN IEC 60068-2-2  
Low temperature: 96 hours, – 40 °C (as per EN IEC 60068-2-1)  
Simulated solar radiation test SA2 and weathering test SB1 as per EN IEC 60068-2-5

## **CERTIFICATE**

**Approbations:** CB (IEC 60947-5-1, IEC60947-5-5), CCC, EN ISO 13850, UL NISD

**Conformities:** CE, UKCA, 2006 / 42 / EC (MD), 2011 / 65 / EC (RoHS)

**REACH:** REACH compliant

**RoHS:** RoHS compliant

## **OTHER**

**Short Description:** Emergency stop switch, Ø 22.3 mm, Ø 32 mm, Mushroom-head, Non illuminated, Red-white, Plastic, according to UL 94 V0, opaque, Round, 1 NC, Maintained, Plug-in terminal, 2.8 x 0.5 mm, IP65, IP66, IP67, according to DIN EN 60529, Twist to unlock

**Material:** Plastic, according to UL 94 V0

**Housing colour:** Yellow

**Housing material:** Plastic, according to UL 94 V0

**Hints:** Twist to unlock clockwise  
Foolproof according to EN IEC 60947-5-5

**Description component:** The double-break switching system can be supplied for the following switching functions: 1 Normally closed, 2 Normally closed, 1 Normally closed + 1 Normally

open. The Normally closed contacts have forced opening according to EN 60947-5-5

**Wiring diagrams:**

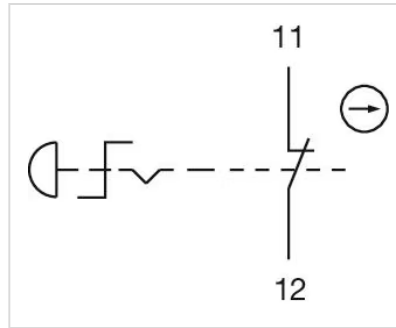

**Component layouts:**

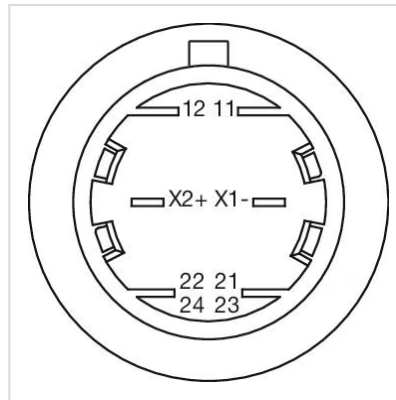

**Mounting cut-outs:**

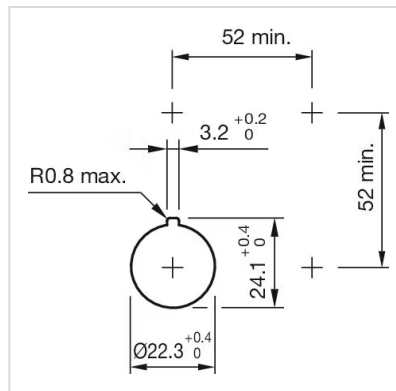

**Dimension drawings:**

