

# Illuminated push button Ø 16 mm silver contact

82-4552.2114

Distribution by  
Newark



<https://newark.eao.com/component/82-4552.2114...>

Your product:

---



## 82-4552.2114

### Illuminated push button Ø 16 mm silver contact

*Loading . . .*

#### **FRONT**

**Front dimension:** Ø 18 mm

**Front form:** Round

**Front bezel material:** Aluminium

**Front bezel shape:** Flush

#### **MOUNTING**

**Mounting cut-out:** Ø 16 mm

**Mounting type:** Panel mounting

#### **OPERATING-/INDICATION PART**

**Lens colour:** Nature

**Lens material:** Aluminium

**Lens illumination:** Illuminated

**Lens shape:** Flush

**Lens optics:** opaque

**Illumination colour:** Red

**Shape of illumination:** Ring

#### **ELECTRICAL CHARACTERISTICS**

**Switching voltage and switching current:**

according to IEC 60947-5-1 (Silver contacts)

Service categorie AC-15

Voltage

24 VAC

35 VAC

110 VAC

220 VAC

Switch rating DC service categorie DC-13 (Silver contacts)

Voltage

24 VDC

35 VDC

110 VDC

220 VDC

Current

1 A

1 A (M12 version)

1 A

0.5 A

Current

0.7 A

0.5 A (M12 version)

0.2 A

0.1 A

according to UL 508 (Silver contacts)

$\cos\phi$  0,75 ... 0,8

Voltage

120 VAC

240 VAC

24 VAC

Current

5 A

3 A

1 A

<b>Contacts:</b>	1 C
<b>Operating voltage:</b>	24 V AC/DC
<b>Operation current:</b>	7 mA
<b>Rated Operational Voltage Ue:</b>	250 VAC
<b>Rated insulation voltage Ui:</b>	250 V
<b>Short circuit protective device:</b>	fuse / 500 V / 5 A / gG
<b>Rated short-circuit current caused:</b>	AC: 1 kA DC: 1 kA
<b>Switching rating:</b>	240 V
<b>Electrical lifetime:</b>	50 000 cycles of operation
<b>Electric strength:</b>	1500 VAC, 50 Hz 1 minute between life terminals and ground
<b>Pollution degree:</b>	2, according to EN IEC 60947-1
<b>Thermal current Ith:</b>	5 A

## MECHANICAL CHARACTERISTICS

<b>Terminal:</b>	Screw terminal
<b>Contact material:</b>	Silver
<b>Switching action:</b>	Maintained
<b>Switching system:</b>	Snap-action switching element
<b>Mechanical lifetime:</b>	500 000 cycles of operation
<b>Operating force:</b>	4 N ... 7 N
<b>Operating Travel:</b>	ca. 3 mm

**Tightening torque:** 0.5 ... 0.6 Nm, Screw terminal 0.1 Nm  
**Weight:** 0.018 kg

### AMBIENT CONDITION

**IP front protection:** IP65, IP67  
**Operating temperature:** - 30 °C ... + 70 °C  
**Storage temperature:** - 40 °C ... + 80 °C  
**Shock resistance:** Max. 500 m / s<sup>2</sup> as per IEC 60068-2-27  
**Vibration resistance:** 10 ... 500 Hz, amplitude 1.5 mm p-p according to IEC 60068-2-6  
**Climate resistance:** Damp heat, 21 days according to IEC 60512-11

### CERTIFICATE

**Approbations:** CB, CCC, C UL, UL  
**Conformities:** CE, 2011 / 65 / EC (RoHS), 2014 / 35 / EU (LVD)  
**REACH:** REACH compliant  
**RoHS:** RoHS compliant

### OTHER

**Short Description:** Illuminated push button Ø 16 mm silver contact, Maintained, 240 V, 24 V AC/DC, 1 C, Screw terminal, Round, Aluminium, Red, Nature  
**Kind of illumination:** Single-LED  
**Housing size:** 16 mm  
**Wiring diagrams:**



**Component layouts:**



**Mounting cut-outs:**

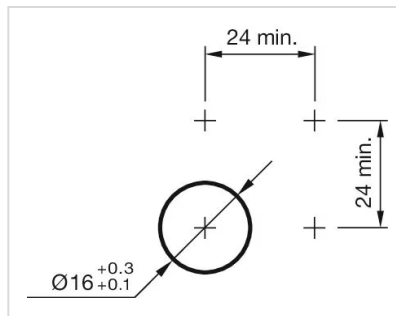

**Dimension drawings:**

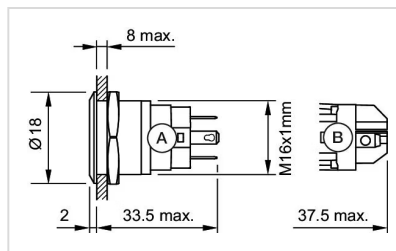

A = Solder terminal  
B = Screw terminal