

# Indicator 16 mm

82-4551.0134

Distribution by  
Newark



<https://newark.eao.com/component/82-4551.0134...>

Your product:

---



## 82-4551.0134 Indicator 16 mm

*Loading ...*

### FRONT

|                              |           |
|------------------------------|-----------|
| <b>Front dimension:</b>      | Ø 18 mm   |
| <b>Front form:</b>           | Round     |
| <b>Front bezel material:</b> | Aluminium |
| <b>Front bezel shape:</b>    | Flush     |

### MOUNTING

|                          |                |
|--------------------------|----------------|
| <b>Mounting cut-out:</b> | Ø 16 mm        |
| <b>Mounting type:</b>    | Panel mounting |

### OPERATING-/INDICATION PART

|                               |             |
|-------------------------------|-------------|
| <b>Lens colour:</b>           | Nature      |
| <b>Lens material:</b>         | Aluminium   |
| <b>Lens illumination:</b>     | Illuminated |
| <b>Lens shape:</b>            | Flush       |
| <b>Lens optics:</b>           | opaque      |
| <b>Illumination colour:</b>   | Green       |
| <b>Shape of illumination:</b> | Ring        |

### ELECTRICAL CHARACTERISTICS

|   |  |         |
|---|--|---------|
| <b>Switching voltage and switching current:</b> | according to UL 508 (Silver contacts)<br>cosφ 0,75 ... 0,8 |         |
|   | Voltage  | Current |
|   | 120 VAC  | 5 A     |
|   | 240 VAC  | 3 A     |
|   | 24 VAC   | 1 A     |

according to IEC 60947-5-1 (Silver contacts)

Service categorie AC-15

Voltage

24 VAC

35 VAC

110 VAC

220 VAC

Switch rating DC service categorie DC-13 (Silver contacts)

Voltage

24 VDC

35 VDC

110 VDC

220 VDC

Current

1 A

1 A (M12 version)

1 A

0.5 A

Current

0.7 A

0.5 A (M12 version)

0.2 A

0.1 A

|  |  |
|--|--|
| <b>Operating voltage:</b>                  | 24 V AC/DC   |
| <b>Operation current:</b>                  | 7 mA   |
| <b>Rated Operational Voltage Ue:</b>       | 250 VAC  |
| <b>Rated insulation voltage Ui:</b>        | 250 V  |
| <b>Short circuit protective device:</b>    | fuse / 500 V / 5 A / gG                                    |
| <b>Rated short-circuit current caused:</b> | AC: 1 kA<br>DC: 1 kA                                       |
| <b>Electrical lifetime:</b>                | 50 000 cycles of operation                                 |
| <b>Electric strength:</b>                  | 1500 VAC, 50 Hz 1 minute between life terminals and ground |
| <b>Pollution degree:</b>                   | 2, according to EN IEC 60947-1                             |
| <b>Thermal current Ith:</b>                | 5 A  |

## MECHANICAL CHARACTERISTICS

|                           |                                  |
|---------------------------|----------------------------------|
| <b>Terminal:</b>          | Soldering terminal, 2.8 x 0.5 mm |
| <b>Tightening torque:</b> | 0.5 ... 0.6 Nm                   |
| <b>Weight:</b>            | 0.018 kg                         |

## AMBIENT CONDITION

|                               |  |
|-------------------------------|--|
| <b>IP front protection:</b>   | IP65, IP67   |
| <b>Operating temperature:</b> | - 30 °C ... + 70 °C  |
| <b>Storage temperature:</b>   | - 40 °C ... + 80 °C  |
| <b>Shock resistance:</b>      | Max. 500 m / s <sup>2</sup> as per IEC 60068-2-27              |
| <b>Vibration resistance:</b>  | 10 ... 500 Hz, amplitude 1.5 mm p-p according to IEC 60068-2-6 |
| <b>Climate resistance:</b>    | Damp heat, 21 days according to IEC 60512-11                   |

## CERTIFICATE

**Approbations:** CB, CCC, C UL, UL

**Conformities:** CE, 2011 / 65 / EC (RoHS), 2014 / 35 / EU (LVD)

**REACH:** REACH compliant

**RoHS:** RoHS compliant

**OTHER**

**Short Description:** Indicator 16 mm, 24 V AC/DC, Soldering terminal, 2.8 x 0.5 mm, Round, Aluminium, Green, Nature

**Kind of illumination:** Single-LED

**Housing size:** 16 mm

**Wiring diagrams:**



**Component layouts:**

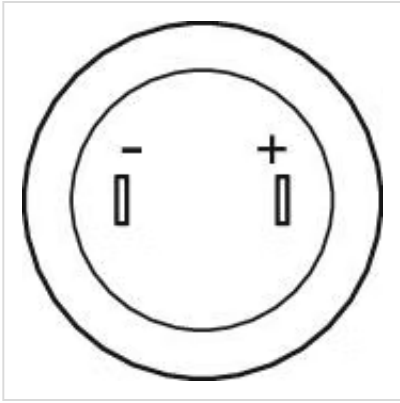

**Mounting cut-outs:**

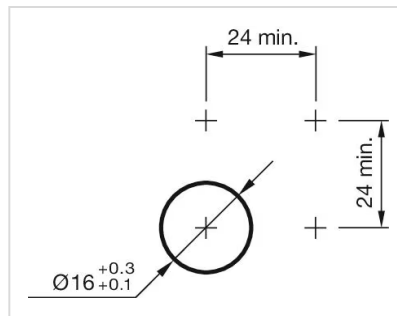

**Dimension drawings:**

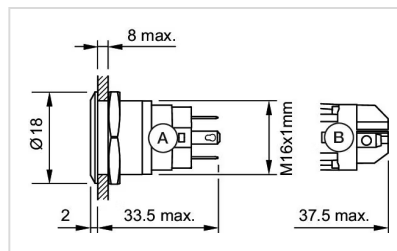

A = Solder terminal  
B = Screw terminal