

# Front bezel set with anti-twist ring

61-9932.10

Distribution by  
Newark



<https://newark.eao.com/component/61-9932.10/e...>

Your product:

---



## 61-9932.10

### Front bezel set with anti-twist ring

*Loading ...*

#### FRONT

<b>Front dimension:</b>	Ø 25 mm
<b>Front form:</b>	Round
<b>Front bezel colour:</b>	Black
<b>Front bezel material:</b>	Plastic, according to UL 94 V0

#### MOUNTING

<b>Mounting cut-out:</b>	Ø 22.5 mm
<b>Mounting type:</b>	Panel mounting

#### MECHANICAL CHARACTERISTICS

<b>Weight:</b>	0.005 kg
----------------	----------

#### CERTIFICATE

<b>REACH:</b>	REACH compliant
<b>RoHS:</b>	RoHS compliant

#### OTHER

<b>Short Description:</b>	Front bezel set with anti-twist ring, Ø 25 mm, Ø 18 mm, Black, Plastic, according to UL 94 V0
<b>Dimension:</b>	Ø 25 mm
<b>Internal size:</b>	Ø 18 mm
<b>Product attributes:</b>	For selector switch
<b>Mounting cut-outs:</b>	

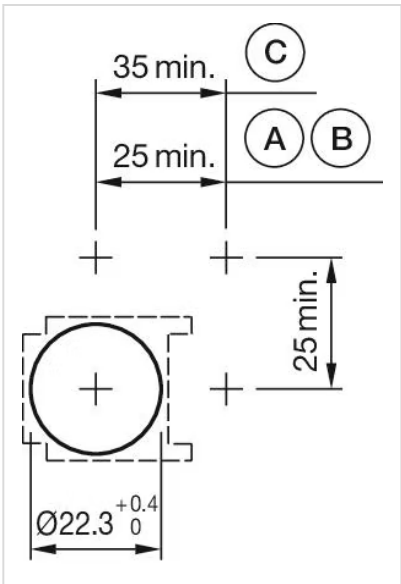
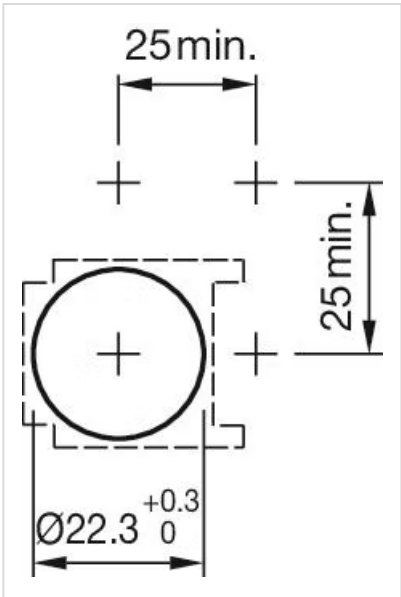

A = Solder/Plug-in terminal 2.8 mm x 0.5 mm

B = Solder terminal

C = Screw terminal