

# Rugged Outdoor Switch

09-RS.1101.6000.M000

Distribution by  
Newark



<https://newark.eao.com/component/09-RS.1101.6...>

Your product:

---



## 09-RS.1101.6000.M000 Rugged Outdoor Switch

*Loading ...*

### FRONT

<b>Front dimension:</b>	Ø 39 mm
<b>Front form:</b>	Round
<b>Front bezel colour:</b>	Black
<b>Front bezel material:</b>	Plastic
<b>Front bezel shape:</b>	Raised

### MOUNTING

<b>Design:</b>	Raised
<b>Mounting cut-out:</b>	Ø 30 mm

### OPERATING-/INDICATION PART

<b>Lens colour:</b>	Blue
<b>Lens material:</b>	Plastic
<b>Lens illumination:</b>	Non illuminated
<b>Lens shape:</b>	Concave
<b>Lens type:</b>	Raised above front bezel
<b>Symbol:</b>	No Symbol

### ELECTRICAL CHARACTERISTICS

<b>Contacts:</b>	1 NO
<b>Contact Type:</b>	Magnetic Reed Switch
<b>Operating voltage:</b>	12 - 48 V DC

<b>Power (W):</b>	10
<b>Switching rating:</b>	48 V DC @ 0,5 A
<b>Electrical lifetime:</b>	1 Mil. cycles of operation
<b>Thermal current I<sub>th</sub>:</b>	0.5 A

## MECHANICAL CHARACTERISTICS

<b>Terminal:</b>	1.5 Series AMP Superseal 3 Pin Connector
<b>Contact material:</b>	Rhodium/Silver
<b>Switching action:</b>	Momentary
<b>Mechanical lifetime:</b>	1 Mil. cycles of operation
<b>Operating force:</b>	25 N
<b>Operating Travel:</b>	5 mm ± 0.1 mm
<b>Tightening torque:</b>	2.5 ... 3 Nm fixing nut
<b>Weight:</b>	0.04 kg

## AMBIENT CONDITION

<b>IP front protection:</b>	IP67 (ISO 20653)
<b>IP Protection:</b>	IP67 rear side (ISO 20653)
<b>Operating temperature:</b>	- 20 °C ... + 100 °C (DIN EN 60068-2-64)
<b>Storage temperature:</b>	- 20 °C ... + 100 °C (DIN EN 60068-2-64)
<b>Vibration resistance:</b>	Vibration TL80101 (2006-10) chapter 4.1.4 test severity level 3, Test Conditions according DIN EN 60068-2-64 test duration 2 hours per spatial axis
<b>Climate resistance:</b>	100 cycles (- 20 °C ... + 100 °C), with 25min at high temperature, 20 min at low temperature level per cycle

## CERTIFICATE

<b>Approbations:</b>	EMC (EN ISO 13766-1:2018), EMC (EN ISO 14982:2009)
<b>Conformities:</b>	CE
<b>REACH:</b>	REACH compliant
<b>RoHS:</b>	RoHS compliant

## OTHER

**Short Description:**

Rugged Outdoor Switch, Momentary, 48 V DC @ 0,5 A, 12 - 48 V DC, 1 NO, 1.5 Series AMP Superseal 3 Pin Connector, Round, Plastic, No Symbol, Blue

**Housing colour:** Black

**Housing material:** Plastic

**Component layouts:**

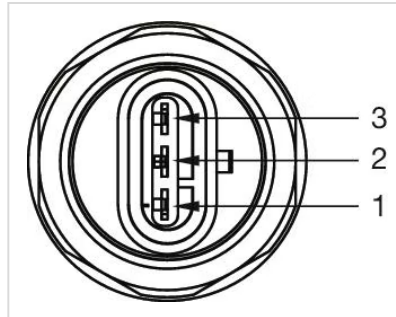

1 = Common +  
2 = Switch Out  
3 = LED - (non illuminated - blank)

**Mounting cut-outs:**

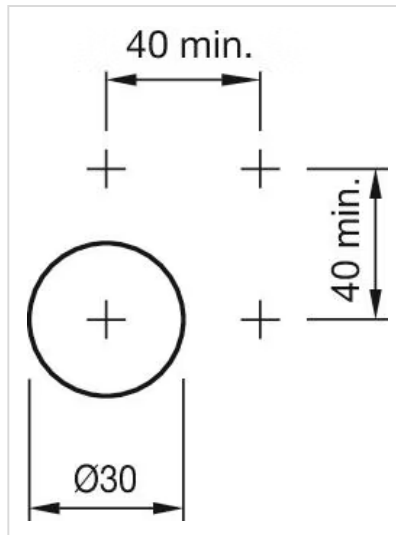

**Dimension drawings:**

