

Rugged Outdoor Switch

09-RS.1101.4100.M001

Distribution by
Newark



<https://newark.eao.com/component/09-RS.1101.4...>

Your product:



09-RS.1101.4100.M001 Rugged Outdoor Switch

Loading . . .

FRONT

| | |
|------------------------------|---------|
| Front dimension: | Ø 39 mm |
| Front form: | Round |
| Front bezel colour: | Black |
| Front bezel material: | Plastic |
| Front bezel shape: | Raised |

MOUNTING

| | |
|--------------------------|---------|
| Design: | Raised |
| Mounting cut-out: | Ø 30 mm |

OPERATING-/INDICATION PART

| | |
|-------------------------------|--------------------------|
| Lens colour: | Zinc yellow |
| Lens material: | Plastic |
| Lens illumination: | Non illuminated |
| Lens shape: | Concave |
| Lens type: | Raised above front bezel |
| Symbol: | PTO |
| Marking symbol colour: | Black |

ELECTRICAL CHARACTERISTICS

| | |
|----------------------|----------------------|
| Contacts: | 1 NO |
| Contact Type: | Magnetic Reed Switch |

| | |
|-----------------------------|----------------------------|
| Operating voltage: | 12 - 48 V DC |
| Power (W): | 10 |
| Switching rating: | 48 V DC @ 0,5 A |
| Electrical lifetime: | 1 Mil. cycles of operation |
| Thermal current Ith: | 0.5 A |

MECHANICAL CHARACTERISTICS

| | |
|-----------------------------|--|
| Terminal: | 1.5 Series AMP Superseal 3 Pin Connector |
| Contact material: | Rhodium/Silver |
| Switching action: | Momentary |
| Mechanical lifetime: | 1 Mil. cycles of operation |
| Operating force: | 25 N |
| Operating Travel: | 5 mm ± 0.1 mm |
| Tightening torque: | 2.5 ... 3 Nm fixing nut |
| Weight: | 0.001 kg |

AMBIENT CONDITION

| | |
|-------------------------------|---|
| IP front protection: | IP67 (ISO 20653) |
| IP Protection: | IP67 rear side (ISO 20653) |
| Operating temperature: | - 20 °C ... + 100 °C (DIN EN 60068-2-64) |
| Storage temperature: | - 20 °C ... + 100 °C (DIN EN 60068-2-64) |
| Vibration resistance: | Vibration TL80101 (2006-10) chapter 4.1.4 test severity level 3, Test Conditions according DIN EN 60068-2-64 test duration 2 hours per spatial axis |
| Climate resistance: | 100 cycles (- 20 °C ... + 100 °C), with 25min at high temperature, 20 min at low temperature level per cycle |

CERTIFICATE

| | |
|----------------------|--|
| Approbations: | EMC (EN ISO 13766-1:2018), EMC (EN ISO 14982:2009) |
| Conformities: | CE |
| REACH: | REACH compliant |
| RoHS: | RoHS compliant |

OTHER

Short Description:

Rugged Outdoor Switch, Momentary, 48 V DC @ 0,5 A, 12 - 48 V DC, 1 NO, 1.5 Series AMP Superseal 3 Pin Connector, Round, Plastic, PTO, Zinc yellow

Housing colour:

Black

Housing material:

Plastic

Component layouts:

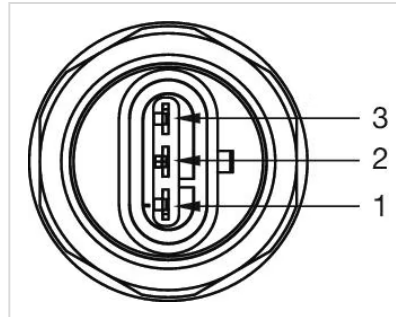

- 1 = Common +
- 2 = Switch Out
- 3 = LED - (non illuminated - blank)

Mounting cut-outs:

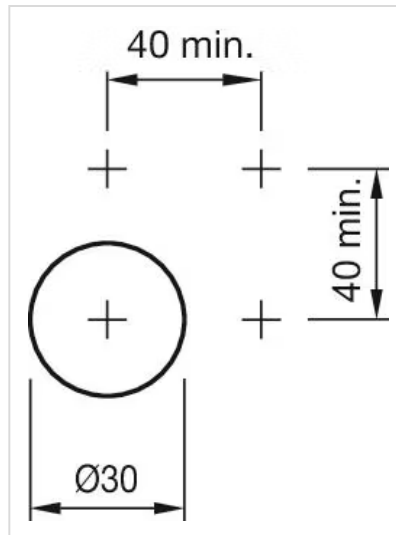

Dimension drawings:

